



SPARK
exhaust technology

SPARK
SPARK.IT

PRODUCT RANGE 2019

WorldSBK
EUGENE LAVERTY
DUCATI PANIGALE V4R



PRODUCT RANGE 2019

SILENCERS RANGE

FORCE



KONIX



EVO 3



EVO 5



70'S



60'S



MEGAPHONE



CLASSIC



MOTO GP



SILENCERS RANGE

RECTANGULAR



GP STYLE



OFF-ROAD



TRUMPET



SINFONIA



DAKAR



HOT ROD



FIGHTER



GRID-O



HOMOLOGATION

N.B. 97/24/CE and **2006/120/CE** directives are respected if you keep the original catalyst or if you mount a Spark homologated system with catalyst. For some products, catalyst is available as spare part.

N.B. European homologation is effective for specified vehicle types only

E3 Spark homologated product includes the catalyst, according Euro3 or previous directives

E3 Spark homologated product without catalyst (you keep the original one) according Euro3 or previous directives

E3 Spark homologated product without catalyst (old homologation or spare part)

E4 Spark homologated product, according Euro4 directives

PRODUCT KEY CODE:

88= FULL SYSTEMS

85= COLLECTORS REMOVING CATALYST

80=OFF ROAD

MATERIAL

I= STAINLESS STEEL

C= CARBON FIBER

D= DARK STYLE

T= TITANIUM

KEY CODE

GBM 0501 D OM

*motorbike
manufacturer*

*sequential
number*

material

homologation

APRILIA

DORSODURO 750 (08-14)
Type SM var. 0 ver. 00



E3 **GAP0301**
RECTANGULAR Slip-on



GAP8501
MANIFOLD to eliminate catalyst



for SHIVER 750 (08-12)
DORSODURO 750
for Spark and original silencers



GAP0401T

*Titanium Link Pipe for aftermarket collector
+ KONIX Slip-on*

GAP0402T

*Titanium Link Pipe for OEM system
+ KONIX Slip-on*





GAP8802T

*RACING FULL TITANIUM SYSTEM
TITANIUM collector + KONIX silencer
SBK version*

GAP8803T

*RACING FULL SYSTEM
S.STEEL collector + FIGHTER silencer (102 db)*



GBE8003T

FULL SYSTEM

stainless steel collector + Off Road silencer



E3 **GBM0901** — — —
MEGAPHONE Slip-On



E3 **GBM0902** — — —
TRUMPET Slip-On

E3 **GBM0903** — — —
SINFONIA Slip-On



BMW

F 700 GS (12-16)

type E8GS var. 0801 ver. A

F 800 GS (08-18) / ADVENTURE (08-18)

type E8GS var. 0219 ver. A



Homologation certificate is not yet updated for Euro4 models



GBM0502 _ _ _
EVO 3 Slip-on

9



it fits with original bags

BMW

F 800 R (09-16)

type E8ST var. 0217 ver. A



GBM0501 _ _ _
EVO 3 Slip-on

9



it can't be mounted with original bags

BMW S 1000 RR (09-14) S1000 R (14-16)
 Type R1ST var.0400 ver.A



E3 GBM0701
 MOTO GP Slip-on



BMW S 1000 RR (15-18)
 Type K10 var. 050F ver.A / Type K10 var. 0D02 ver.A

GBM8805T

RACING FULL SYSTEM

TITANIUM collector + MOTO GP silencer (113 db)

GBM8806T

RACING FULL SYSTEM

STAINLESS STEEL collector + MOTO GP silencer (113 db)



SKIT039
 Mounting kit
 to passengers
 footpeg

In order to mount all BMW S 1000 RR full systems on previous model years (2009-2014) you need to add the optional bushing kit



SKIT019
 bushing kit



SKIT039

Mounting kit
to passengers
footpeg



GBM8803T

RACING FULL SYSTEM
TITANIUM collector + FORCE
silencer (102 db)

FORCE silencer's
length: 350 mm

GBM8804T

RACING FULL SYSTEM
STAINLESS STEEL collector + FORCE
silencer (102 db)

SKIT019

bushing kit

In order to mount all BMW S 1000
RR full systems on previous model
years (2009-2014)
you need to add the optional
bushing kit

GBM8801T

RACING FULL SYSTEM
TITANIUM collector + FORCE silencer
(104 db)

FORCE silencer's
length: 300 mm

GBM8802T

RACING FULL SYSTEM
STAINLESS STEEL collector + FORCE silencer
(104 db)

GBM8811T

RACING FULL SYSTEM EVO 2018
TITANIUM collector + KONIX silencer

GBM8808T

RACING FULL SYSTEM
STAINLESS STEEL collector +
TITANIUM connecting pipe + KONIX silencer





GBM0702T
GRID-O Slip-On





GBM8814T

RACING FULL SYSTEM

TITANIUM collector + KAT + KONIX silencer

GBM8815T

RACING FULL SYSTEM

STAINLESS STEEL collector + KAT + KONIX silencer

GBM8816T

RACING FULL SYSTEM

TITANIUM collector + KONIX silencer



BMW

R1150 R ADV. / R1150 GS / ROCKSTER (99-06)



GBM8501
 MANIFOLD to eliminate catalyst
 stainless steel



replaceable with the original

E3 **GBM0605** _ _ _
 FORCE Slip-on



BMW

R1200 R (11-14)
 Type R1SZ var. 0400 var. A



E3 **GBM0402** _ _ _
 EVO 5 Slip-on



it mounts with original bags



E3 **GBM0403**
FORCE Slip-on



BMW

R1200 GS (06-09)

Type R12 var.0303 ver. A

R1200 GS adventure (06-09)

Type R12 var.0380 ver. A



E3

9

GBM0603

FORCE Slip-on



BMW

R1200 GS 10-12

Type R12 var.0450 ver. A

R1200 GS adventure 10-12

Type R12 var.0470 ver. A



E3

9

GBM0604

FORCE Slip-on



BMW

R1200 GS (13-18)

Type R12W var.0A01 ver. A/B/C/D

R1200 GS adventure (14-18)

Type R12W var.0A01 ver. A/B/C/D



E3 **GBM0602** ---
FORCE Slip-on



Homologation certificate is not updated for Euro4 models

BMW

R1200 GS (13-18)

R1200 GS adventure (13-18)

GBM8507

*MANIFOLD to eliminate catalyst
stainless steel*



E4 **GBM0606**
FIGHTER Slip-on



E4 **GBM0606**
FIGHTER Slip-on



E4 **GBM0606**
FIGHTER Slip-on



BMW

K1200 S (05-08)

Type K12R var.0594 ver.O / Type K12R var.0584 ver.A

K1200 R (05-08)

Type K12S var.0581 ver. A

E3 **GBM0301**
FORCE Slip-on



BMW

R NINE T (14-18)



GBM0803
Double MotoGP Slip-on



*it fits both with original and
Spark collectors*



Homologation certificate is not yet updated for Euro4 models

E3

GBM0802 _ _ _
EVO 5 Slip-on

⑨

it fits both with original and Spark collectors



Homologation certificate is not yet updated for Euro4 models

E3

GBM0801 _ _ _
70's Slip-on

⑨

it fits both with original and Spark collectors



DUCATI

Ducati models are listed as follows:

- 1) Monster models
- 2) Racing models (749, 848, panigale, ecc.)
- 3) Hypermotard
- 4) Multistrada
- 5) Touring
- 6) Diavel
- 7) Streetfighter
- 8) Scrambler

MONSTER

DUCATI

600(94-00)
Type ME 00

620(02-06)
Type M4 var. 03

695(06-07)
Type M4 var. 19 ver. AA

750(94-00)
Type M1

800(03-05)
Type M4 var. 06 ver. A

900(94-99)

1000(03-05)
Type M4 var.04 ver A

S4(01-03)
Type M4



E3 **GDU0807** _ _ _
ROUND Slip-on,
HIGH mounting,
short pipes

homologation valid for
M600/M900



E3 **GDU0812** _ _ _
ROUND Slip-on,
HIGH mounting, short pipes

homologation valid for
M620/695/800/900ie/1000/S4

you have to replace the original indicators



GDUPT02IS
number plate holder OPTIONAL

MONSTER

DUCATI

600(94-00)

620(02-06)

695(06-07)

750(94-00)

800(03-05)

900(94-99)

1000(03-05)

S4(01-03)

Type ME 00

Type M4 var. 03

Type M4 var. 19 ver. AA

Type M1

Type M4 var. 06 ver. A

Type M4 var. 04 ver A

Type M4



E3 **GDU0811** _ _ _
 OVAL Slip-on
 LOW mounting



homologation valid for
 M620/695/800/900ie/1000/S4/M600/900



GDUPT02IS
 number plate holder OPTIONAL

E3 **GDU0810** _ _ _
 ROUND Slip-on
 LOW mounting

homologation valid for
 M620/695/800/900ie/1000/S4



E3 **GDU0804** _ _ _
 ROUND Slip-on
 LOW mounting

homologation valid for
 M600/900

DUCATI

MONSTER S2R 800(04-06)
Type M4 var. 14 ver. AA

MONSTER S2R 800(07-13)
Type M4 var. 14 ver. AA

MONSTER S4R 1000(03-06)
Type M4 var. 14 ver. AA

S2R1000(06-08)

E3 GDU0819COM

ROUND Slip-on

⑨

45°

it fits both with original and spark collectors



GDU8501

MAINFOLD to eliminate catalyst
S2R800 (04-06), S4R (03-06)
stainless steel



it fits both with original and Spark silencers



GDU8508

MAINFOLD to eliminate catalyst
S2R 800 (07-13)
stainless steel



it fits both with original and Spark silencers

E3 GDU0818

ROUND Slip-on

⑨

HIGH mounting left+right



it fits both with original and Spark collectors

GDU8503

MANIFOLD to eliminate catalyst
S2R 1000
stainless steel



it fits both with original and Spark silencers



GDUPT02IS

number plate holder OPTIONAL

E3 **GDU0820** ---
ROUND Slip-on,
HIGH mounting



it fits both with original and Spark collectors



E3 **GDU0823** ---
ROUND Slip-on 45°



it fits both with original and Spark collectors

UNTIL STOCK LASTS

GDUPT02IS
number plate holder OPTIONAL



GDU8504
MANIFOLD to eliminate
catalyst



replaceable with original collector

E3 **GDU0821** ---
OVAL Slip-on,
HIGH mounting



it fits both with original and Spark collectors





GDU8811T

RACING FULL SYSTEM

TITANIUM collector + MOTO GP silencer

UNTIL STOCK LASTS

DUCATI

MONSTER 696 (08-14)

Type A4 var. 03 ver. AA

MONSTER 796 (10-14)

Type M5 var. 06 ver. AA

MONSTER 1100 / S (09-10)

Type M5 var. 2 ver. AA

E3 **GDU0826** _ _ _
 ROUND Slip-on,
 HIGH mounting



you have to replace original number plate holder with GDUPT06I

E3 **GDU0826S** _ _ _
 ROUND (only silencers)



they fit to Spark RACING pipe only



GDUPT06I
 number plate older
 with LED light
 stainless steel



GDU0826 R
 RACING pipe
 stainless steel



it fits to Spark silencers only

E3 **GDU0827** _ _ _
 MEGAPHONE Slip-on
 HIGH mounting



E3 **GDU0827S** _ _ _
 MEGAPHONE (only silencers)



they fit to Spark RACING pipe only





E3 **GDU0829** _____
5 9 ROUND Slip-on,
 HIGH mounting



E3 **GDU0829S** _____
 ROUND only silencers,
 HIGH mounting
 it fits with Spark
 pipe only



GDU0829R
 racing tubes to
 silencer, stainless
 steel

it fits with Spark silen-
 cer only



GDUPT091
 number plate holder
 with LED light
 stainless steel

You have to replace original number plate holder with **GDUPT091**



E3 **GDU0828** _____
5 9 EVO 5 Slip-on,
 STANDARD
 mounting with Y pi-
 pes and heat shield



E3 **GDU0828S** _____
 EVO 5 silencers
 STANDARD mounting



it fits with Spark
 pipe only



GDU0828R
 RACING Y pipe to
 silencers
 stainless steel

it fits with Spark silen-
 cer only

DUCATI **MONSTER 821 (14-17)**

Type M6 var.04 ver. AA

E3 **GDU0831** _ _ _
FORCE Slip-on
 (with KAT)



FULL SYSTEM
 COMPLETE KIT VERSION
 GDU8516+
 GDU0830R+
 GDU0831SDOM



E3 **GDU0831S** _ _ _
FORCE only silencer

it fits with Spark
 pipe only

GDU0830R
RACING pipe
 stainless steel



GDU0832R
RACING pipe
 titanium

it fits with Spark silen-
 cer only

GDU8516
RACING manifold
 stainless steel



GDU8517
RACING manifold
 titanium

DUCATI **MONSTER 1200 2014-15**

Type M6 var.01 ver. AA

E3 **GDU0830** _____
 FORCE Slip-on
 (with KAT)



E3 **GDU0830S** _____
 FORCE only silencer

it fits with Spark pipe only



GDU0830R
 RACING pipe
 stainless steel

GDU0832R
 RACING pipe
 titanium

it fits with Spark silen-
 cer only

GDU8516
 RACING manifold
 stainless steel

GDU8517
 RACING manifold
 titanium



DUCATI

MONSTER 1200 R (16/18)



GDU0835_
MotoGP Slip-on



DUCATI MONSTER 1200 R (2016)

GDU0836_ **LIMITED**
MotoGP Slip-on **EDITION**



DUCATI 748 / 748R / 916 / 996 / 998



E3 **GDU1103** _ _ _
OVAL Slip-on
ONLY FOR SPARK CENTRAL BODY

homologation valid for 748(95-98)/916(94-98)



GDU1102
stainless steel
CENTRAL BODY
only for Spark
silencers D.50



E3 **GDU1105** _ _ _
OVAL Slip-on
ONLY FOR SPARK CENTRAL BODY

homologation valid for 748(99-02)/748R/996/998



E3 **GDU1101** _ _ _
OVAL Slip-on
homologation valid for 748(95-98)/916(94-98)



E3 **GDU1104** _ _ _
OVAL Slip-on
homologation valid for 748(99-02)
748R/996/998



GDUAC001

carbon fiber heat shield



ON DEMAND

E3 GDU1501TOM

EVO 2 Slip-on
(with number plate and light holder)

it fits both with original and Spark collectors



MANIFOLD TO ELIMINATE THE CATALYST

FOR **HIGH** oil pan models

GDU8505 stainless steel pipe

GDU8506 stainless steel pipe
they mount in pairs only

FOR **LOW** oil pan models

GDU8505 stainless steel pipe

GDU8507 stainless steel pipe
they mount in pairs only



DUCATI

749/999



E3 **GDU8803** _ _ _

FULL RACING KIT

EVO2 silencer + stainless steel manifold D. 52-60-52 +number plate

Holder and lighth support

(for LOW oil pan and black swingarm models)

DUCATI

848/848 Evo/1098/1098s/1198 (08-10)

848(08-10)

Type H6 var. 00 ver. AA

E3 **GDU1701**
 RECTANGULAR Slip-on
 (kat included)



E3 **GDU1701S**
 only RECTANGULAR silencers
 they fit with Spark pipes only



GDU1701R
 RACING PIPES



GDUAC002
 carbon fiber heat shield for
 Spark FULL SYSTEM



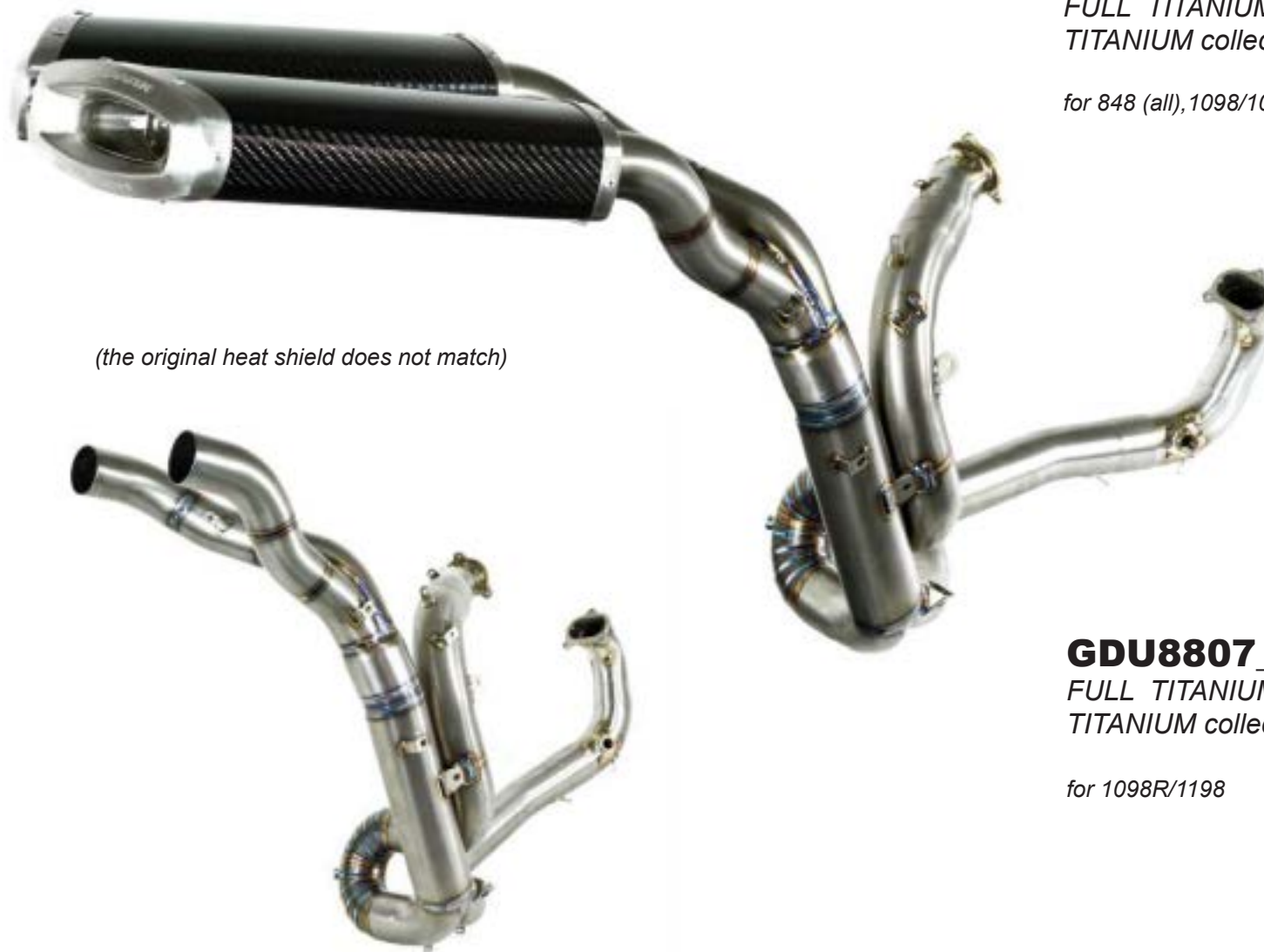

(the original heat shield does not match)

GDU8805_

FULL TITANIUM SYSTEM

TITANIUM collectors d.60-70-54 + RECTANGULAR silencers

for 848 (all), 1098/1098S

GDUAC002

**carbon fiber heat shield for
Spark FULL SYSTEM**



GDU8807_

FULL TITANIUM SYSTEM

TITANIUM collectors d.60-70-54 + RECTANGULAR silencers

for 1098R/1198



GDU8808T
FULL TITANIUM SYSTEM



GDU8819T

3/4 SYSTEM

S.STEEL link pipe + GRID-O Silencer
(112dB)



GDUAC004

ECU maps



GDUAC006

Carbon Fiber heat shield (optional)



GDU8820T

3/4 SYSTEM

TITANIUM link pipe + GRID-O Silencer
(112dB)





GDU8821T

3/4 SYSTEM

S.STEEL link pipe + FORCE Silencer
(102dB)



GDUAC004

ECU maps



GDUAC006

Carbon Fiber heat shield (optional)



GDU8822T

3/4 SYSTEM

TITANIUM link pipe + KONIX Silencer
(106dB)



GDU8823T

3/4 SYSTEM

S.STEEL link pipe + GRID-O Silencer +
FORCE Silencer (102dB)



GDUAC006

Carbon Fiber heat shield (optional)



GDUAC004

ECU maps

GDU8824T

3/4 SYSTEM

TITANIUM link pipe + GRID-O Silencer +
FORCE Silencer (102dB)



GDUAC006

Carbon Fiber heat shield (optional)



GDUAC004

ECU maps



GDU8825T

FULL TITANIUM SYSTEM

TITANIUM collectors + 2 GRID-O Silencers



GDUAC005

ECU maps



GDUAC006

Carbon Fiber heat shield
(optional)



DUCATI HYPERMOTARD 796(09-12)

Type B1 var.01 ver A4

E3 **GDU1801** _ _ _
 ROUND Slip-on
 standard mounting underseat



GDU8513
 racing MANIFOLD
 to remove the catalyst
 stainless steel

replaceble with the original

E3 **GDU1803** _ _ _
 OVAL Slip-on
 side mounting
 (lateral)



you have to replace original
 plate holder with **GDUPT071**

you have to add aftermarket side
 fairings



GDUPT071
 number plate holder for OVAL Spark silencer



GDU1804R
2 in 1 RACING pipe
stainless steel



it fits with Spark silencer only

E3 **GDU1804S** _ _ _
FORCE only silencer



it fits with Spark pipes only

GDU1807R
RACING pipe
stainless steel
it mounts with clamp to original collector



it fits with Spark silencer only



E3 **GDU1804** _ _ _
*FORCE Slip-on
LOW mounting
(Homologated version
includes 2 KAT)*



you have to replace original number plate holder with GDUPT12I



E3 **GDU1805**
FORCE Slip-on
HIGH mounting

it does not fit with original bags



E3 **GDU1805S**
only FORCE silencer
HIGH mounting

it fits with Spark pipe only



GDU1805R
2 in 1 RACING pipe
stainless steel
it fits with Spark silencer only



GDUPT12I
number plate holder for HIGH mounting Spark silencer



GDU01806
MOTO GP Slip-on
standard mounting



DUCATI HYPERMOTARD 1100 / S / EVO / EVO SP (07-12)

Type: B1 var. 00 ver. AA / Type: B1 var. 03 ver. AA / Type: B1 var. 04 ver. AA

E3 **GDU1801** _____
 ROUND Slip-on
 (Y underseat pipe included)



it fits both whit original and Spark collectors

GDUPT07I
 stainless steel number plate holder for OVAL Spark silencer



GDU8511
 pipe to eliminate the valve



it fits with original or Spark silencer

E3 **GDU1802** _____
 OVAL Slip-on

it fits both with original and Spark collectors



you have to replace number plate holder (GDUPT07I) and side fairings



GDU8512
 racing MANIFOLD
 to remove the catalyst
 stainless steel



for hypermotard 1100 EVO / EVO SP

replaceable with the original

GDU8510
 racing MANIFOLD
 to remove the catalyst
 stainless steel

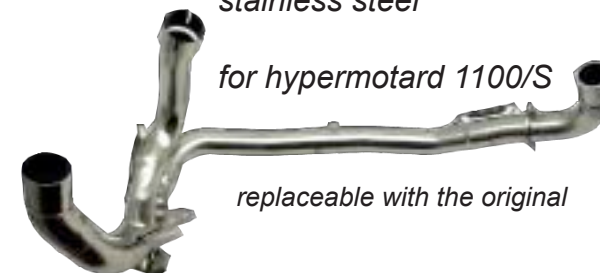

for hypermotard 1100/S

replaceable with the original

G9976

Optional dB Killer-
to special grid for
SPARK MANIFOLD



GDU8523

racing MANIFOLD
to remove the catalyst
titanium



G9976

Optional dB Killer-
to special grid for
SPARK MANIFOLD



GDU8522

racing MANIFOLD
to remove the catalyst
stainless steel

DUCATI

MULTISTRADA 1000(03-06)



GDU8502
racing MANIFOLD
to remove the catalyst
stainless steel

replaceable with the original

DUCATI

MULTISTRADA 1100(07-09)



GDU8509
racing MANIFOLD
to remove the catalyst
stainless steel

replaceable with the original

DUCATI

MULTISTRADA 1200(10-14)
Type A2 var. 00

E3 **GDU1602** ---
EVO 3 Slip-on
with heat shield



UNTIL STOCK LASTS

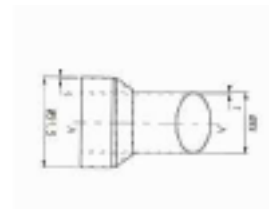

G9933
front db killer for **GDU8515**



GDU1603 ---
MOTO GP Slip-on
with heat shield



GDU8515
SILENCED MANIFOLD to
remove the catalyst

replaceable with the original

DUCATI

MULTISTRADA 1200 S / PIKES PEAK (15/17)



GDU8812
FULL SYSTEM
STAINLESS STEEL collector + FORCE silencer



G9976
Optional dB Killer-
to special grid for
SPARK MANIFOLD



GDU8518
racing MANIFOLD
to remove the catalyst
stainless steel





GDU8813_
FULL SYSTEM
TITANIUM collector + FORCE silencer



G9976
Optional dB Killer-
to special grid for
SPARK MANIFOLD

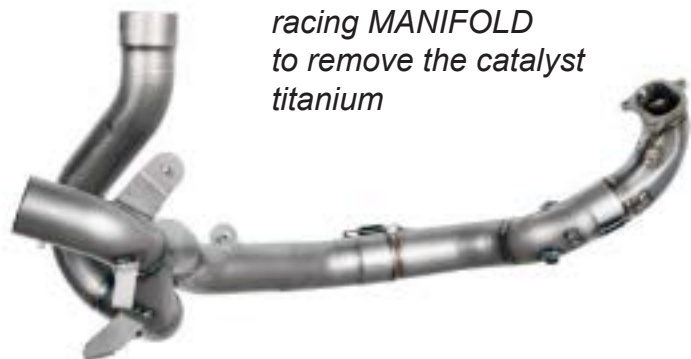

GDU8519
racing MANIFOLD
to remove the catalyst
titanium





GDU8521
*racing MANIFOLD
to remove the catalyst
titanium*



G9976
*Optional dB Killer-
to special grid for
SPARK MANIFOLD*



GDU8520
*racing MANIFOLD
to remove the catalyst
stainless steel*



GDU8525
racing MANIFOLD
to remove the catalyst
titanium



G9976
Optional dB Killer-
to special grid for
SPARK MANIFOLD



GDU8524
racing MANIFOLD
to remove the catalyst
stainless steel



DUCATI

750 SS (91-97)



E3 **GDU0302** _ _ _
*ROUND Slip-on
HIGH mounting*

DUCATI

750SS IE- 900 SS IE(98-02)



E3 **GDU0401** _ _ _
*ROUND Slip-on
LOW mounting*

E3 **GDU0402** _ _ _
*ROUND Slip-on
HIGH mounting*

DUCATI

851/900 SS(91-97)



E3 **GDU0501** _ _ _
ROUND Slip-on
LOW mounting

E3 **GDU0502** _ _ _
ROUND Slip-on
HIGH mounting

DUCATI

ST2



E3 **GDU0901** _ _ _
ROUND Slip-on

DUCATI

ST4-ST4 S (98-99)



E3 **GDU1001** _ _ _
OVAL Slip-on

DUCATI

DIAVEL (11-16)

Type G1 var. 00 ver. AB



E3 **GDU2001** _ _ _ _
EVO 5 Slip-on

5 9

UNTIL STOCK LASTS





E3 **GDU2101** _____
CLASSIC double Slip-on
⑤ ⑨



E3 **GDU2102** _____
EVO 5 Slip-on
⑤ ⑨



GDU2103I

60's Slip-on



GDU2104I

GP STYLE Slip-on





GGU0101_
Force Slip-on





E4 **GGU0201** _ _ _
70's Slip-on



HARLEY DAVIDSON

TOURING models
(TWIN CAM engine 103)



GHA8501

racing MANIFOLD to remove the catalyst

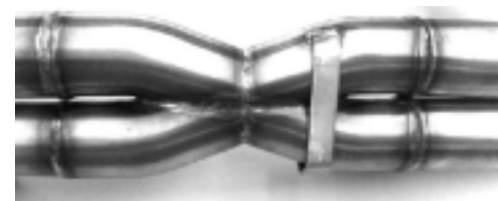

UNTIL STOCK LASTS

HONDA

CRF 250 (14-17)



GH08009D

FULL SYSTEM

stainless steel collector + Off Road silencers

dB 112,0



HONDA

CRF 250 (18-19)



GHO8011_
FULL SYSTEM
stainless steel collector + Off Road silencers





GHO8002D (11-12) *dark style*

GHO8004D (13-14) *dark style*

GHO8006D (15-16) *dark style (dB 114)*

*FULL SYSTEM
stainless steel collector + dark silencer*

HONDA

CRF 450 (17-19)



GH08010T

FULL SYSTEM

stainless steel collector + dark silencer



HONDA

CB 500 F (13-15) / R (13-15) / X (15-16)

Type PC45 var. 1 ver. 1

E3 GH01301_ _ _
KONIX Slip-on





GHO8828T

FULL SYSTEM

TITANIUM collector + FORCE silencer

HONDA

NC 700 D/X/S (12-14)

NC 750 X / S (14-18)

INTEGRA (14-18)

NM4 VULTUS



E3 **GH01102** ---
⑨ *FORCE Slip-on*

Homologation certificate is not yet updated for Euro4 models

E3 **GH01101** ---
⑨ *EVO 5 Slip-on*



Homologation certificate is not yet updated for Euro4 models



E3 **GHO1801** ---
KONIX Slip-On





E3 **GHO1601** _ _ _
FORCE Slip-On

Homologation certificate is not yet updated for Euro4 models



HONDA

CRF 1000L AFRICA TWIN (17) / AFRICA TWIN ADVENTURE SPORT (18)

E3 **GHO1701**
DAKAR Slip-On



Homologation certificate is not yet updated for Euro4 models



GHO8810
FULL SYSTEM
STAINLESS STEEL collector + DAKAR silencer



HONDA

CRF 1000L AFRICA TWIN (20)



E4 GHO1702_ _ _



GHO8820T

ON DEMAND

FULL SYSTEM

S.STEEL collector + Force silencer



GHO8822T

ON DEMAND

FULL SYSTEM 102 dB

S.STEEL collector + Force silencer (1.350mm)



HONDA

VTR 1000 F (97-99) | VTR 1000 SP-1 (00-01)

E3 **GHO0601** _____
OVAL Slip-on

for VTR 1000 F



HONDA

CROSS TOURER 1200 (12-18)

Type SC70 var. 1. ver. 1



E3 **GHO1401** _____
⑨ **FORCE Slip-on**



Homologation certificate is not yet updated for Euro4 models

HONDA

GOLD WING 1800(13-17)

Type GL1800B/D/C/MT



E3 **GHO1501** _____
⑨ **RECTANGULAR Slip-on**



HUSQVARNA

FE 250 (17) / FC 350 (17) / 450 (17)



GHU0401D

OFF ROAD Slip On
FE/FC 250 (17)
FE/FC 350 (17)
FE/FC 450 (17)

HUSQVARNA

FE 350 (2017) ENDURO

GHU8002D

FULL SYSTEM

stainless steel collector + dark silencer



GHU0401D

OFF ROAD Slip-On
dark style





GKA8002D (2012) *dark style*

GKA8006D (2017) *dark style*

FULL SYSTEM

stainless steel collector + dark silencer

dB 114

*dB with dB killer **G9970** - 112,3*

*dB with dB killer **G9925** - 111*



KAWASAKI

NINJA 300 (13-17)

Type EX300A var. A ver. 1A



GKA0701_
MOTO GP Slip-on



it fits with original collector





GKA1001_
KONIX Slip-on



GKA1002_
KONIX Slip-on



GKA8823T

FULL SYSTEM

STAINLESS STEEL collector + KONIX silencer



GKA8824T

FULL SYSTEM

TITANIUM collector + KONIX silencer



GKA8825T

FULL SYSTEM

STAINLESS STEEL collector + FORCE silencer

102dB



GKA8826T

titanio

GKA8826C

carbonio

FULL SYSTEM

STAINLESS STEEL collector + MOTO GP silencer



GKA8821T titanium
FULL SYSTEM
TITANIUM collector + KONIX silencer
WorldSuperSport version

GKA8822T titanium
FULL SYSTEM
STAINLESS STEEL collector + KONIX
silencer



GKA8807T
FULL SYSTEM
TITANIUM collector + FORCE
silencer
102dB



GKA8806T
FULL SYSTEM
STAINLESS STEEL collector + FORCE
silencer
102dB

KAWASAKI

Z750 - (07-14)
Type ZR750N var. N ver. 1A



E3 **GKA0402** _ _ _
MEGAPHONE Slip-on



SGATT121
Valve simulator
stainless steel

KAWASAKI

Z800 E - (13-16)
Type ZR800A var. A ver. 3

E3 **GKA0403** _ _ _
FORCE Slip-on



GKA0404 _
MOTO GP Slip-on



GKA8501
racing MANIFOLD
stainless steel



replaceable with the original



KAWASAKI

Z800 - (13-16)

Type ZR800N var. A ver. 1/2 / Type ZR800N var. B ver. 1/2



GKA0406_
MOTO GP Slip-on
for Z800



E3 **GKA0405_**
FORCE Slip-on

GKA8502
racing MANIFOLD
stainless steel



replaceable with the original



WSBK TEAM GOELEVELN



GKA8802T *titanium*

FULL SYSTEM
TITANIUM collector + FORCE silencer
STOCK version D.60
102 dB

GKA8803T *s.steel*

FULL SYSTEM
STAINLESS STEEL collector + FORCE
silencer
EWC version D.60



GKA8814T

FULL SYSTEM
TITANIUM collector + FORCE silencer
102 dB - D.65



KAWASAKI

ZX 10-R (11-19) Racing



GKA8815T

FULL TITANIUM SYSTEM SBK
TITANIUM collector +KONIX silencer

107dB



GKA8820T

GKA8820C

FULL TITANIUM SYSTEM SBK

TITANIUM collector +MOTO GP silencer





GKA8819_

3/4 SYSTEM

TITANIUM link pipe + KONIX Silencer



GKA8817T

3/4 SYSTEM

TITANIUM link pipe + FORCE silencer
- L.300 mm (107 dB)



GKA8816_

3/4 SYSTEM

TITANIUM link pipe + MotoGP Silencer

GKA8818T

3/4 SYSTEM

TITANIUM link pipe + FORCE silencer
- L.350 mm (102 dB)

GKA8828T

FULL TITANIUM SYSTEM SBK
TITANIUM collector + GRID-O silencer

*Per montare il kit bisogna eliminare
lo scambiatore ACQUA / OLIO e
montare*

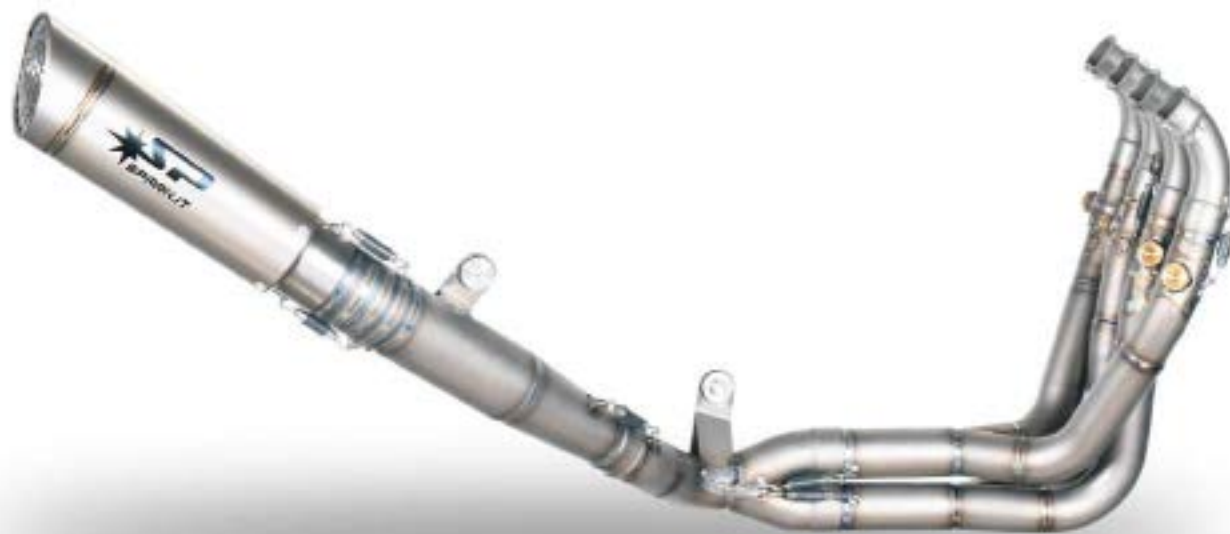

KAWASAKI

H2 (15)



GKA0801_
MOTO GP Slip-On



GKA0802_
FORCE Slip-On

UNTIL STOCK LASTS





GKA0804_
FORCE Slip-On



KAWASAKI

ZX 14 (06-15) / ZX 14 R (12/18)



GKA8813T

FULL SYSTEM

*stainless steel collector +
KONIX silencer*



KTM

DUKE 125 (11-16)

Type KTM IS DUKE var.A1 / Type KTM IS DUKE var.A2 / Type KTM IS DUKE var.A3

KTM DUKE 200(12-15)

Type KTM IS DUKE var. A4



E3
⑤ ⑨

GKT0101

GP STYLE Slip-on
HIGH mounting



E3
⑤ ⑨

GKT0102

GP STYLE Slip-on
LOW mounting



KTM

SX-F 250



GKT8001D

(11-12)

GKT8003D

(2013)

GKT8005D

(14-15)

GKT8006D

dB 109

(16-17)

FULL SYSTEM

stainless steel collector + dark silencer

UNTIL STOCK LASTS

GKT8006D fits on **HUSQVARNA FC 250 (16)** also (Page 60)





GKT8005D (14-16)
GKT8008D (2017)

FULL SYSTEM
stainless steel collector + dark silencer

UNTIL STOCK LASTS



GHU0401D
OFF ROAD Slip On
SX-F 250 / 350 / 450 (16-17)
EXC-F 250 / 350 / 450 (17)



GKT8007D (16-17)
FULL SYSTEM
stainless steel collector + dark silencer

GKT8007D fits on **HUSQVARNA FC 350 (2016)** also

UNTIL STOCK LASTS



GKT8009D

FULL SYSTEM

stainless steel collector + dark silencer

UNTIL STOCK LASTS



GKT0104 _ _ _
MEGAPHONE Slip on
HIGH mounting

UNTIL STOCK LASTS



E3 **GKT0108** _____
⑤ ⑨ *KONIX Slip-On*



GKT0109 _____
MOTO GP Slip-On





E3 **GKT0302** ---
KONIX Slip-On

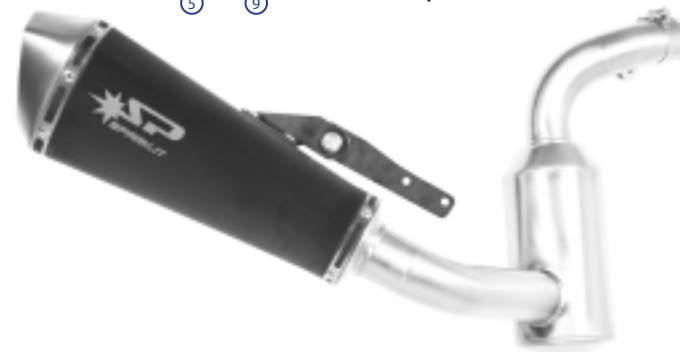

GKT0303_
MOTO GP Slip-On





E4 **GKT0110T** --
GRID-O Slip-On





Homologation certificate is not yet updated for Euro4 models



E4 **GKT0204** *FIGHTER Slip-on*



KTM

SUPERDUKE 1290 (14-16)
Type KTM superduke var. A1/A2

E3 **GKT0105** _____
FORCE Slip-on



GKT8501
RACING pipe connection
stainless steel



replaceable with the original

GKT0106 _____
MOTO GP Slip-on



SUZUKI

RM-Z 250 / 450 (16/17)



GSU8004D

FULL SYSTEM

stainless steel collector + dark silencer
for RM-Z 250

it fits also on 2010-2015 models

dB 111

UNTIL STOCK LASTS

GSU8005D

FULL SYSTEM

stainless steel collector + dark silencer
for RM-Z 450

dB 113,5

dB with dB killer **G9925** - 111,5

UNTIL STOCK LASTS



SUZUKI

GSR 750 (11-15)

Type C5 var. 1 ver. 1



GSU1002TOM

EVO 5 Slip-on



GSU1003IOM

Gp STYLE Slip-on



SUZUKI

GSX S 1000 (15-18)



GSU1101_
MotoGp Slip-On



SUZUKI

GSX R 1000 (17-19)



GSU0104_
KONIX Slip-On



GSU0105_
MOTO GP Slip-On



GSU8811T

FULL TITANIUM SYSTEM
TITANIUM collector + KONIX silencer



GSU8812T

FULL TITANIUM SYSTEM
TITANIUM collector + GRID-O silencer



GSU8813T

FULL SYSTEM
S:STEEL collector + FORCE silencer
(102 dB)



E4 **GSU1201TOM**
FIGHTER Slip-On



TRIUMPH

STREET TRIPLE RS / R / S 765 (18-19)



E4

GTR0502TOM

3/4 SYSTEM

S.STEEL box + GRID-O Silencer



G9980

GRID-O dB Killer



GTR8501

Racing S.STEEL Collector



TRIUMPH

STREET TRIPLE RS / R / S 765 (18-19)

GTR0501T

3/4 SYSTEM

TITANIUM link pipe + GRID-O Silencer



GTR0501R

TITANIUM Racing link pipe for Spark silencer
(spare parts)



G9980

GRID-O dB Killer



TRIUMPH

TIGER 800 (11-18)

Type A08 2/3



E3 **GTR0301** _ _ _
FORCE Slip-on

Homologation certificate is not yet updated for Euro4 models

TRIUMPH

TIGER 1200 (12-15)

Type V13VG



E3 **GTR0302** _ _ _
FORCE Slip-on

TRIUMPH

SCRAMBLER (05-15)
Type 986MG2



E3 **GTR8802I** _ _
FULL SYSTEM
2In2 silencer + s.steel collector



*The exhaust can be installed on BONNEVILLE and THRUXTON by adding mounting kit **SKIT067**. In order to install the exhaust on such models you have to replace the side fairing and check the position of the brake pump*

TRIUMPH

SCRAMBLER 1200 XC / XE (19)



E4 **GTR8810I** _ _
70'S Slip-on

TRIUMPH

BONNEVILLE SE (05-15)

Type 986MF

SPIRIT THRUXTON

Type 986ME2



E3 **GTR0201** _ _ _
⑤ ⑥ 70'S Slip-on



E3 **GTR0204** _ _ _
70'S Slip-on



GTR0207 _
MEGAPHONE Slip-on



GTR0205 _
TRUMPET Slip-on



GTR0206 _
SINFONIA Slip-on



TRIUMPH

BONNEVILLE T100 (05-15)

Type 986MF



GTR8807_
FULL SYSTEM

2In1 silencer + s.steel collector

SPECIAL EDITION



TRIUMPH ||| BONNEVILLE T120 (16-18)

E4 **GTR0208** ---
TRUMPET Slip-on



Mounts with original catalyst



E4 **GTR0209** ---
SINFONIA Slip-on



Mounts with original catalyst



E4

GTR8804

FULL SYSTEM

2in2 HOT ROAD Evolution



TRIUMPH

THRUXTON 1200 / 1200 R (16-18)

E4

GTR8809

FULL SYSTEM

2in2 HOT ROAD Evolution



E4 **GTR0401** _ _ _
60'S Slip-on



E4 **GTR0403** _ _ _
SINFONIA Slip-on



E4 **GTR0402** _ _ _
TRUMPET Slip-on





E4 **GTR8804** _ _ _
FULL SYSTEM
2in2 HOT ROAD Evolution





E3 GPI8801_ _ _ _
FORCE Slip-on
⑤ ⑨



Homologation certificate is not yet updated for Euro4 models

E3 GPI8802_ _ _ _
FORCE Slip-on
⑤ ⑨



Homologation certificate is not yet updated for Euro4 models

GYA1402_
KONIX Slip-On



GYA1401_
MOTO GP Slip-On



YAMAHA

YZF R3 (15/19)



GYA8856_

FULL SYSTEM (2018 EVOLUTION)
S.STEEL collector + KONIX silencer

GYA8833_

FULL SYSTEM (2018 EVOLUTION)
TITANIUM collector + KONIX silencer



GYA8855_

FULL SYSTEM (2018 EVOLUTION)
STAINLESS STEEL collector + MOTO GP silencer



GYA8857T

FULL SYSTEM (2018 EVOLUTION)
STAINLESS STEEL collector + FORCE silencer

102 dB



YAMAHA

X-MAX 400 (13-16)
Type SH07 var. A ver. 01



E3
5 9

GYA1202
FORCE Slip-on
(with removable catalyst)

GKAT01
Spare part catalyst



YAMAHA

SR 400 (13-16)



GYA1302I
CLASSIC Slip-on
98 dB
Stainless steel



GYA8003D

FULL SYSTEM

stainless steel collector + dark silencer



GYA8807

FULL SYSTEM

stainless steel collector + FORCE silencer
(catalyst included) (01-07)



GYA8815

FULL SYSTEM

stainless steel collector + FORCE silencer
(catalyst included) (08-11)



E3

5 9

GYA8814

FULL SYSTEM

stainless steel collector + FORCE silencer
(catalyst included)



GYA8805T

FULL SYSTEM (106 dB)
STAINLESS STEEL collector +
KONIX silencer



GYA8808T

FULL SYSTEM (106 dB)
TITANIUM collector + KONIX silencer

optional db killer G9954: 103 db

GYA8853T

FULL SYSTEM (102 dB)
STAINLESS STEEL collector + FORCE silencer

GYA8854T

FULL SYSTEM (102 dB)
TITANIUM collector + FORCE silencer



GYA0306_

KONIX Slip-on
(98db)



GYA0305_

MOTO GP Slip-on
(100db)



GYA8824T

FULL SYSTEM (112 dB)
STAINLESS STEEL collector + MOTO GP silencer

GYA8825T

FULL SYSTEM (112 dB)
TITANIUM collector + MOTO GP silencer



GYA8838T

FULL SYSTEM (102 dB)

STAINLESS STEEL collector + FORCE silencer

GYA8839T

FULL SYSTEM (102 dB)

TITANIUM collector + FORCE silencer



GYA8840T

FULL SYSTEM

STAINLESS STEEL collector + KONIX silencer

GYA8841T

FULL SYSTEM

TITANIUM collector + KONIX silencer



GYA8851T

FULL SYSTEM

STAINLESS STEEL collector + MOTO GP silencer

GYA8852T

FULL SYSTEM

TITANIUM collector + MOTO GP silencer





GYA8863T

FULL SYSTEM EVO 2019 (102 dB)

STAINLESS STEEL collector + FORCE silencer

GYA8864T

FULL SYSTEM EVO 2019 (102 dB)

TITANIUM collector + FORCE silencer



GYA8865T

FULL SYSTEM EVO 2019

TITANIUM collector + KONIX silencer



GYA8867T

FULL SYSTEM EVO 2019

TITANIUM collector + GRID-O silencer

GYA8866T

FULL SYSTEM EVO 2019

TITANIUM collector + MOTO GP silencer





STANDARD mounting

E3 **GYA8820** _ _ _

5 9

FULL SYSTEM

stainless steel collector + FORCE silencer
STANDARD mounting
(catalyst included)



Homologation certificate is not yet updated for Euro4 models

E3 **GYA8820S** _ _ _

FORCE only silencer
it fits to Spark collector only



GYA8820R

RACING collector STD mounting
stainless steel
it fits to Spark silencer only



HIGH mounting

E3 **GYA8821** _ _ _

5 9

FULL SYSTEM

stainless steel collector + FORCE silencer
HIGH mounting
(catalyst included)



Homologation certificate is not yet updated for Euro4 models

GYA8821S _ _ _

FORCE only silencer
it fits to Spark collector only



GYA8821R

RACING collector HIGH mounting
stainless steel
it fits to Spark silencer only





E3 **GYA0502** ---
OVAL Slip-on

YAMAHA

MT-09 Tracer (15-19)

Type RN29 var. 1-2-3-4-5 ver. A / Type RN29 var. 6-7-8-9 ver. A



E4 GYA8862IOM

FULL SYSTEM

stainless steel collector + GRID-O silencer

STANDARD mounting



YAMAHA

MT-09 Tracer (15-19)

Type RN29 var. 1-2-3-4-5 ver. A / Type RN29 var. 6-7-8-9 ver. A



GYA8870T

FULL SYSTEM

stainless steel collector + GRID-O silencer

STANDARD mounting





HIGH mounting

E3 **GYA8817** _ _ _

⑤ ⑨

FULL SYSTEM

stainless steel collector + FORCE silencer
HIGH mounting
(catalyst included)



Homologation certificate is not yet updated for Euro4 models

E3 **GYA8817S** _ _ _

FORCE only silencer
it fits to Spark collector only



GYA8817R

RACING collector HIGH
mounting
stainless steel
it fits to Spark silencer only



STANDARD mounting

E3 **GYA8816** _ _ _

⑤ ⑨

FULL SYSTEM

stainless steel collector + FORCE silencer
STANDARD mounting
(catalyst included)



Homologation certificate is not yet updated for Euro4 models

E3 **GYA8816S** _ _ _

FORCE only silencer
it fits to Spark collector only



GYA8816R

RACING collector STD mounting
stainless steel
it fits to Spark silencer only





E3

5 9

GYA8816 _ _ _

FULL SYSTEM

stainless steel collector + **FORCE** silencer

STANDARD mounting

(catalyst included)



Homologation certificate is not yet updated for Euro4 models



E3

GYA8816S _ _ _

FORCE only silencer

it fits to Spark collector only



GYA8816R

RACING collector **STD** mounting

stainless steel

it fits to Spark silencer only



E3 **GYA8835S** _ _ _
EVO5 silencer
it fits only to
STD mounting
Spark collector



GYA8816R
STD mounting RACING collector
stainless steel
It fits to Spark silencer only



GYA8816K
STD mounting Catalysed collector
stainless steel
It fits to Spark silencer only





GYA0905_
KONIX Slip-On



GYA0904_
MOTO GP Slip-On



GYA8846T

3/4 SYSTEM

TITANIUM collector + FORCE silencer
holder to be fixed to rider's footpeg



GYA8848T

3/4 SYSTEM

TITANIUM collector + KONIX silencer
holder to be fixed to rider's footpeg

GYA8845T

3/4 SYSTEM

S.STEEL collector + FORCE silencer
holder to be fixed to rider's footpeg



GYA8830T

3/4 SYSTEM

TITANIUM collector + MOTO GP silencer
holder to be fixed to rider's footpeg



GYA0904_
*MOTO GP Slip-On
for original manifold*



GYA0905_
*KONIX Slip-On
for original manifold*



GYA8828 _

3/4 SYSTEM

STAINLESS STEEL collector + FORCE silencer holder to be fixed to rider's footpeg

GYA8829 _

3/4 SYSTEM

TITANIUM collector + FORCE silencer holder to be fixed to rider's footpeg



GYA8868 _

3/4 SYSTEM

TITANIUM collector + KONIX silencer holder to be fixed to rider's footpeg



GYA8830T

3/4 SYSTEM

TITANIUM collector + MOTO GP silencer holder to be fixed to rider's footpeg

SKIT068

MOUNTING KIT FOR R1 CUP TROPHY

SKIT040

valve eliminator kit

GYA8831T

FULL SYSTEM
STAINLESS STEEL collector +
FORCE silencer
holder to be fixed to rider's footpeg

GYA8832T

FULL SYSTEM
TITANIUM collector +
FORCE silencer
holder to be fixed to rider's footpeg



GYA8869T

FULL SYSTEM
TITANIUM collector +
FORCE silencer
holder to be fixed to rider's footpeg

WORLD ENDURANCE VERSION 102dB

SKIT068

MOUNTING KIT FOR R1 CUP TROPHY

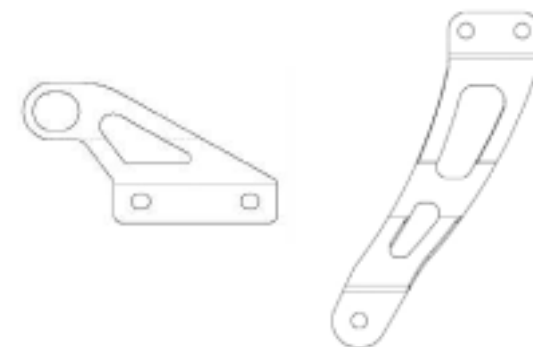

GYA8847T

FULL TITANIUM SYSTEM

TITANIUM collector + KONIX silencer (107dB)



GYA8850T

FULL TITANIUM SYSTEM

TITANIUM collector + MOTO GP silencer



SKIT040

valve eliminator kit



UNIVERSAL SILENCER GP STYLE

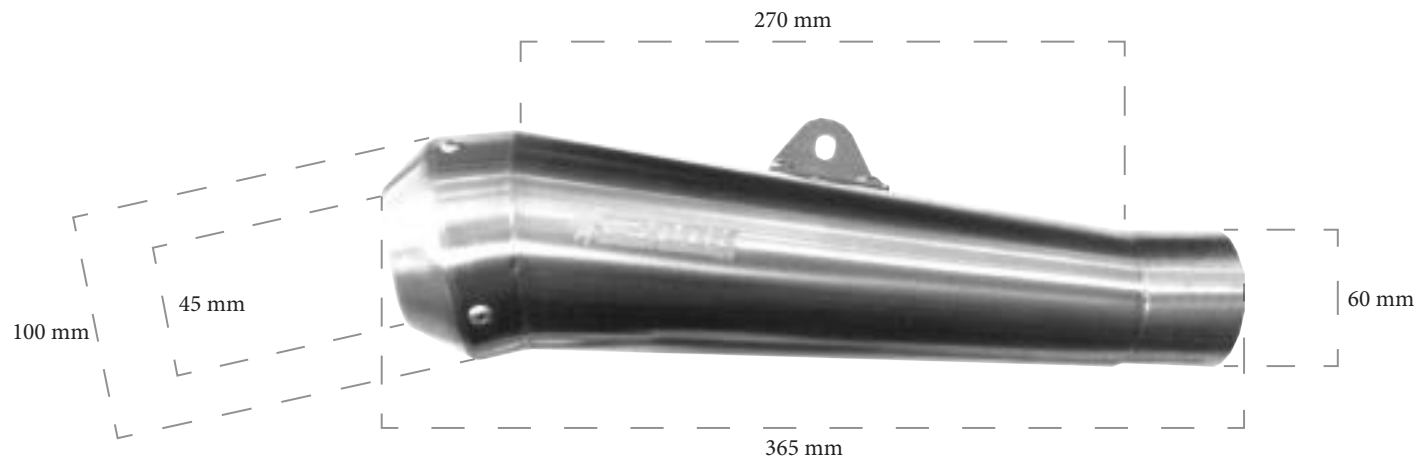

Ø **60**

G00SI04I
G00SI04B

GP STYLE Racing
stainless steel
db killer included
(left or right)

UNIVERSAL SILENCER CLASSIC



Ø **45**

G00SI07I

CLASSIC stainless steel
db killer included (left or right)



UNIVERSAL SILENCER

MEGAPHONE



\varnothing **60**
G00SI06IP
 stainless steel polished
 db killer included
 (left or right)



\varnothing **60**
G00SI06IM
 stainless steel mat
 db killer included
 (left or right)



\varnothing **60**
G00SI06D
 dark style
 db killer included
 (left or right)



UNIVERSAL SILENCER 60'S



Ø **60**

G00SI10I

*60's stainless steel
(left or right)*



UNIVERSAL SILENCER MOTO GP

Ø **60**

G00SI11_

MOTO GP titanium (left or right)



UNIVERSAL SILENCER MOTO GP

\varnothing **60**
G00SI08T titanium
G00SI08I stainless steel
 MOTO GP (right)



\varnothing **60**
G00SI09T
 MOTO GP (left) titanium



UNIVERSAL SILENCER TRUMPET

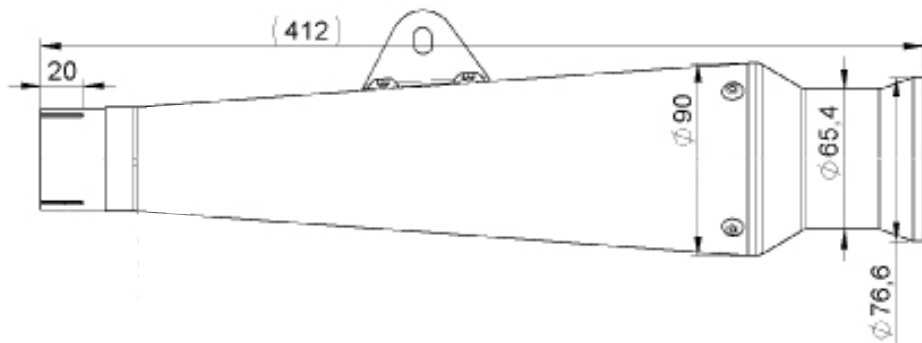

Ø45



G00SI121
TRUMPET
stainless steel
(left or right)

- Custom works -
SPARK
- EST^o 2015 -

UNIVERSAL SILENCER SINFONIA

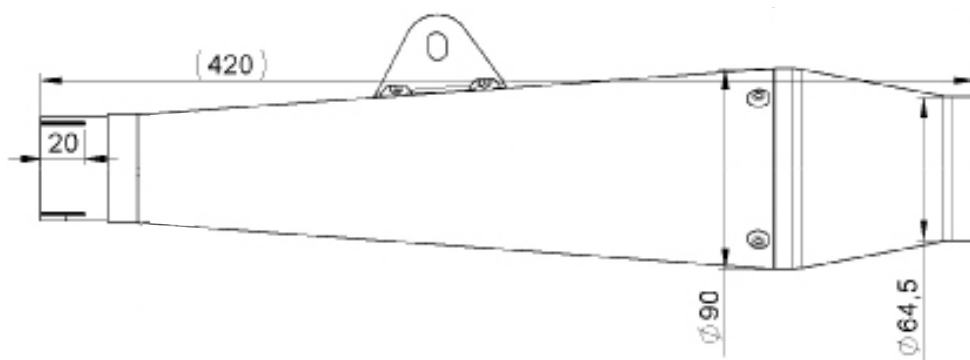

Ø45



G00SI131
SINFONIA
stainless steel
(left or right)

- Custom works -
SPARK
- EST^o 2015 -

UNIVERSAL SILENCER HOT ROD

G00SI18I/B

*HOT ROD
stainless steel
(left)*

G00SI19I/B

*HOT ROD
stainless steel
(right)*



UNIVERSAL SILENCER FORCE



Ø **54**
Ø **60**

| | | |
|-----------------|----------------|------------|
| G00SI20T | l.300mm | Ø54 |
| G00SI21T | l.300mm | Ø60 |
| G00SI28T | l.300mm | Ø65 |
| G00SI22T | l.350mm | Ø54 |
| G00SI23T | l.350mm | Ø60 |

*FORCE titanium
(left or right)*

UNIVERSAL SILENCER KONIX



Ø **54**
Ø **60**

| | | |
|-----------------|----------------|------------|
| G00SI24T | l.300mm | Ø54 |
| G00SI25T | l.300mm | Ø60 |
| G00SI25T | l.300mm | Ø65 |

*KONIX titanium
(left or right)*

UNIVERSAL SILENCER GRID-O

G00SI26T \varnothing **60**

G00SI30T \varnothing **65**



UNIVERSAL SILENCER



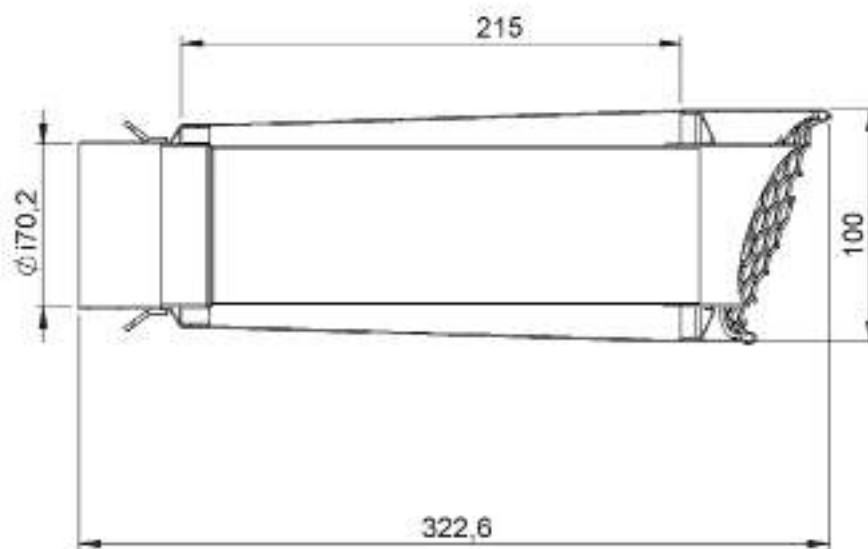

GRID-O WSBK REPLICA

Ø70
G00SI27T



PIPE COMPONENTS

PIPE THICKNESS 1 mm, scotch brite finishing

| | Ø40 | Ø45 | Ø50 | Ø54 | Ø60 |
|--|---------------|---------------|---------------|---------------|---------------|
| <p>BENDED PIPE 30°</p>  | G 9101 | G 9104 | G 9116 | G 9107 | G 9110 |
| <p>BENDED PIPE 45°</p>  | G 9102 | G 9105 | G 9114 | G 9108 | G 9111 |
| <p>BENDED PIPE 90°</p>  | G 9103 | G 9106 | G 9113 | G 9109 | G 9112 |
| <p>PIPE 50 CM</p>  | G 9001 | G 9002 | G 9005 | G 9003 | G 9004 |



SGMA14
CONIC ADAPTER
60mm-->40mm
LENGHT 110 mm



G95LA006 (D.63,5)
G95LA009 (D.53,5)
G95LA007 (D.47,5)
G95LA003 (D.43,5)



SGATT104



SGATT273



TAPPO007
PLUG M 18x1,5 H=10mm
TAPPO017
PLUG M 12X1,25 H=9mm



MOLLA01 83mm
MOLLA02 63mm
(Spring)



SGATT068
(hook for spring)

DB KILLER

| | | |
|------------------|---|--------------|
| DB KILLER | CLASSIC - d.47,3 d.32 00° OPEN | G9939 |
| DB KILLER | EVO 2 - 80x36,5 int.37x21 00° HOMOLOG. | G9913 |
| DB KILLER | EVO3 - d.47,3 d.35 15° 14 HOLES | G9917 |
| DB KILLER | EVO5 - d.51,5 d.35 00° 28 HOLES | G9928 |
| DB KILLER | FOR MANIFOLD GDU8515 -d.51,5 d.35-BENDED | G9933 |
| DB KILLER | FORCE - d.25 00° 16 HOLES (scooter) | G9958 |
| DB KILLER | FORCE - d.35 00° 30 HOLES | G9942 |
| DB KILLER | FORCE - d.40 00° - EXIT 16,5° | G9955 |
| DB KILLER | FORCE - d.40 00° OPEN | G9954 |
| DB KILLER | GP STYLE - d.47,3 d.25 16° 20 HOLES | G9948 |
| DB KILLER | GP STYLE - d.47,3 d.32 16° OPEN | G9922 |
| DB KILLER | MEGAPHONE, EVO3 - SIL.REDUC.PIPE | G9918 |
| DB KILLER | MOTO GP - d.47,3 d.35 00° 21 HOLES | G9950 |
| DB KILLER | MOTO GP - d.57,5 d.35 00° 21 HOLES | G9941 |
| DB KILLER | OFF ROAD - d. 34 ENDURO | G9925 |
| DB KILLER | OFF ROAD - d. 34 d.38 19° OPEN | G9924 |
| DB KILLER | OFF ROAD | G9970 |
| DB KILLER | RECTANGULAR - 35,8x59,8 int.41,3x15,3 00° l.150 | G9915 |
| DB KILLER | ROUND - d. 47 d.32 18° OPEN | G9912 |
| DB KILLER | ROUND - d. 57,5 d.32 21° OPEN | G9909 |
| DB KILLER | ROUND, MEGAPHONE - d.47,3 d.32 34° 28 HOLES (Monster) | G9914 |
| DB KILLER | SIL.REDUC.PIPE d.57,5 d.35 00° | G9969 |
| DB KILLER | FORCE - d.35 00° | G9944 |
| DB KILLER | SIL.REDUC.PIPE d.51,5 d.40 00° | G9931 |
| DB KILLER | SIL.REDUC.PIPE d.60,5 d.32 00° | G9971 |
| DB KILLER | SIL.REDUC.PIPE d.57,5 d.40 00° | G9973 |
| DB KILLER | SIL.REDUC.PIPE NO KAT MULTISTRADA | G9976 |
| DB KILLER | SIL.REDUC.PIPE HOT ROAD | G9977 |
| DB KILLER | SIL.REDUC.PIPE GRID-O | G9980 |

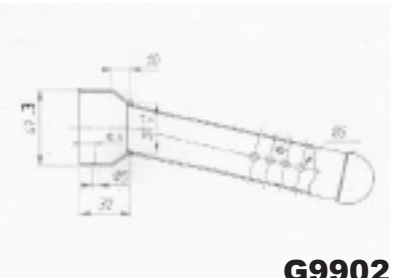

G9902

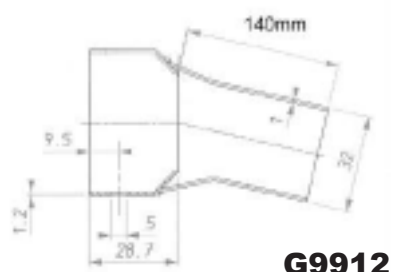

G9912

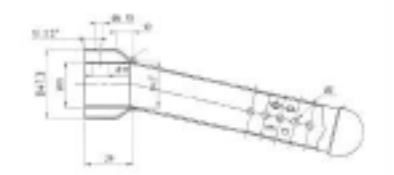

G9914

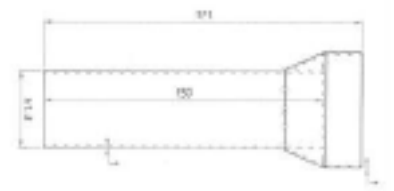

G9915

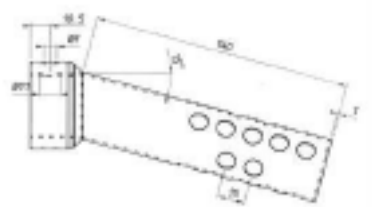

G9917

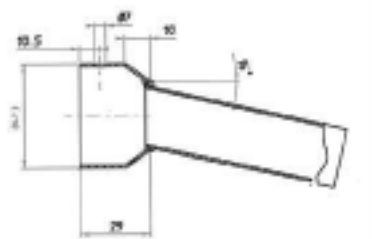

G9922

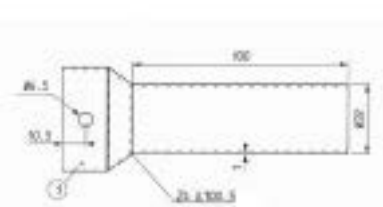

G9939

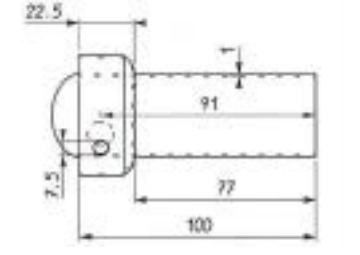

G9944

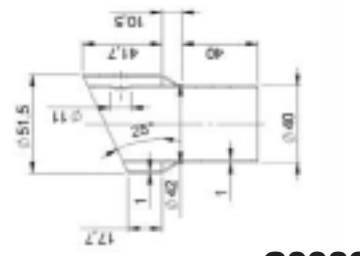

G9980

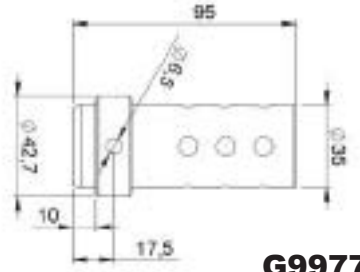

G9977

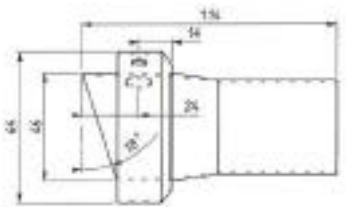

G9954